

TECHNICAL MANUAL }
No. 9-1240-335-35P }

HEADQUARTERS
DEPARTMENT OF THE ARMY
WASHINGTON, D.C., 1 April 1970

DIRECT SUPPORT, GENERAL SUPPORT, AND DEPOT

MAINTENANCE

REPAIR PARTS AND SPECIAL TOOLS LIST

**TELESCOPE M97 (1240-360-1593), M97G
(1240-732-1470) AND M97H (1240-732-1469)**

SECTION		Paragraph	Page
	I. INTRODUCTION		
	Scope -----	1	2
	General -----	2	2
	Explanation of columns -----	3	2
	Special information -----	4	3
	How to locate repair parts -----	5	4
	Abbreviations -----	6	4
	Federal supply codes for manufacturers -----	7	4
	Recommendations for maintenance publications -----	8	4
	II. REPAIR PARTS FOR DIRECT SUPPORT, GENERAL SUPPORT, AND DEPOT MAINTENANCE -----		5
	III. SPECIAL TOOLS, TEST AND SUPPORT EQUIPMENT FOR DIRECT SUPPORT, GENERAL SUPPORT, AND DEPOT MAINTENANCE -----		27
	IV. INDEX-FEDERAL STOCK NUMBER AND REFERENCE NUMBER CROSS- REFERENCED TO FIGURE AND ITEM NUMBER -----		28

*This manual supersedes ORD 8 SNL F-235 Vol 16, May 52, C1, July 53, C2, 6 Feb 57, C3, 30 Jan 62, ORD 9 SNL F-235 Vol 16, Jan 53 and C1, 10 Nov 54

Section I. INTRODUCTION

1. Scope

This manual lists repair parts, special tools, and equipment required for the performance of direct support, general support, and depot maintenance of the Telescope M97, M97G and M97H.

2. General

This Repair Parts and Special Tools List is divided into the following sections:

a. *Repair Parts-Section II.* A list of repair parts for the performance of maintenance at the direct support, general support, and depot level in figure and item number sequence.

b. *Special Tools, Test and Support Equipment - Section III.* Not applicable.

c. *Federal Stock Number and Reference Number Index-Section IV.* A list of Federal stock numbers in ascending numerical sequence followed by a list of reference numbers in ascending alpha-numeric sequence, cross-referenced to the illustration figure number and item number.

3. Explanation of Columns

The following provides an explanation of columns in the tabular list in Section II.

a. *Source Maintenance and Recoverability Codes (SMR), Column 1:*

(1) Source code, indicates the selection status and source for the listed item. Source codes are:

<i>Code</i>	<i>Explanation</i>
P	Repair parts, special tools, and test equipment which are stocked in or supplied from the GSA/DSA, or Army supply system and authorized for use at indicated maintenance categories.
P2	Repair parts, special tools, and test equipment which are procured and stocked for insurance purposes because the combat or military essentiality of the end item dictates that a minimum quantity be available in the supply system.
P9	Assigned to items which are NSA design controlled: unique repair parts, special tools, test, measure and diagnostic equipment, which are stocked and supplied by the Army COMSEC logistic system, and which are not subject to the provisions of AR 380-41.
P10	Assigned to items which are NSA design controlled: special tools, test, measuring and diagnostic equipment for COMSEC support, which are accountable under the provision of AR 380-41, which are stocked and supplied by the Army COMSEC logistic system.
M	Repair parts which are not procured or stocked, but are to be manufactured in indicated levels.
A	Assemblies which are not procured or stocked as such, but are made up of two or more units. Such component units carry individual stock numbers and descriptions, are procured and stocked separately and can be assembled to form the required assembly at indicated maintenance categories.

<i>Code</i>	<i>Explanation</i>
X	Parts and assemblies which are not procured or stocked and the mortality of which normally is below that of the applicable end item or component. The failure of such part or assembly should result in retirement of the end item from the supply system.
X1	Repair parts which are not procured or stocked. The requirements for such items will be filled by use of the next higher assembly or component.
X2	Repair parts which are not stocked. The indicated maintenance category requiring such repair parts will attempt to obtain same through cannibalization. Where such repair parts are not obtainable through cannibalization, requirements will be requisitioned, with accompanying justification, through normal supply channels.
G	Major assemblies that are procured with PEMA funds for initial issue only as exchange assemblies at DSU and GSU level. These assemblies will not be stocked above DS and GS level or returned to depot supply level.

(2) Maintenance code, indicates the lowest category of maintenance authorized to install the listed item. The maintenance level codes are:

<i>Code</i>	<i>Explanation</i>
O	Organizational maintenance
F	Direct support maintenance
H	General support maintenance
D	Depot maintenance.

(3) Recoverability code, indicates whether unserviceable items should be returned for recovery or salvage. Items not coded are expendable. Recoverability codes are:

<i>Code</i>	<i>Explanation</i>
R	Applied to repair parts (assemblies and components) which are considered economically repairable at direct and general support maintenance levels. When the maintenance capability to repair these items does not exist, they are normally disposed of at the GS level. When supply considerations dictate, some of these spare parts may be listed for automatic return to supply for depot level repair as set forth in AR 710-50. When so listed, they will be replaced by supply on an exchange basis.
S	Repair parts and assemblies which are economically repairable at DSU and GSU activities and which normally are furnished by supply on an exchange basis. When items are determined by a GSU to be uneconomically repairable, they will be evacuated to a depot for evaluation and analysis before final disposition.

Code Explanation

T High dollar value recoverable repair parts which are subject to special handling and are issued on an exchange basis. Such repair parts normally are repaired or overhauled at depot maintenance activities.

U Repair parts specifically selected for salvage by acclamation units because of precious metal content, critical materials, or high dollar value reusable casings or castings.

b. *Federal Stock Number, Column 2.* This column indicates the Federal stock number assigned to the item and will be used for requisitioning purposes.

c. *Description, Column 3* This column indicates the Federal item name and any additional description of the item required. The abbreviation "w/e" when used as a part of the nomenclature, indicates the Federal stock number includes all armament, equipment, accessories, and repair parts issued with the item. A part number or other reference number is followed by the applicable five-digit Federal supply code for manufacturers in parentheses.

d. *Unit of Measure (U/M), Column 4.* A 2 character alphabetic abbreviation indicating the amount or quantity of the item upon which the allowances are based e.g., ft, ea, pr, etc.

e. *Quantity Incorporated in Unit, Column 5* This column indicates the quantity of the item used in the assembly group. A "V" appearing in this column in lieu of a quantity indicates that a definite quantity cannot be indicated (e.g., shims, spacers, gaskets, etc.).

f. *30-Day DS/GS Maintenance Allowances, Columns 6 and 7.*

Note. Allowances in GS column are for GS maintenance only.

(1) The allowance columns are divided into three sub columns. Indicated in each subcolumn, opposite the first appearance of each item, is the total quantity of items authorized for the number of equipments supported. Subsequent appearances of the same item will have the letters "REF" in the applicable allowance columns. Items authorized for use as required but not for initial stockage are identified with an asterisk in the allowance column.

(2) The quantitative allowances for DS/GS levels of maintenance will represent initial stockage for a 30-day period for the number of equipments supported.

(3) Determination of the total quantity of parts required for maintenance of more than 100 of these equipments can be accomplished by converting the equipment quantity to a decimal factor by placing a decimal point before the next to last digit of the number to indicate hundredths, and multiplying the decimal

factor by the parts quantity authorized in the 51-100 allowance column. Example, authorized allowance for 51-100 equipments is 40; for 150 equipments multiply 40 by 1.50 or 60 parts required.

g. *1-Year Allowances Per 100 Equipments/Contingency Planning Purposes, Column 8.* This column indicates opposite the first appearance of each item the total quantity required for distribution and contingency planning purposes. The range of items indicates total quantities of all authorized items required to provide for adequate support of 100 equipments for one year.

h. *Depot Maintenance Allowance Per 100 Equipments, Column 9.* This column indicates opposite the first appearance of each item, the total quantity authorized for depot maintenance of 100 equipments. Subsequent appearances of the same item will have the letters "REF" in the allowance column. Items authorized for use as required but not for initial stockage are identified with an asterisk in the allowance column.

i. *Illustration, Column 10.* This column is divided as follows:

(1) *Figure Number, Column 10a.* Indicates the figure number of the illustration in which the item is shown.

(2) *Item Number, Column 10b.* Indicates the callout number used to reference the item in the illustration.

4. Special information

a. Telescopes M97, M97G and M97H are used with the following end items with their supporting publications:

Telescope M97

TM 9-2350-201-20P Organizational Maintenance Repair Parts and Special Tools List for Tank, Combat, Full-Tracked: 76MM Gun, M41, M41A1, M41A2 and M41A3 and Trainer, Tank Gunnery 76MM Gun M17

Telescopes M97G and M97H

TM 9-2350-208-20P Organizational Maintenance Repair Parts and Special Tools List for Tank, Combat Full-Tracked: 90MM Gun M48A2, Tank, Combat, Full-Tracked: 90MM Gun M48A2C, Tank,

Combat, Full-Tracked: Flame Thrower
M67A1

Telescope M97H

TM 9-7012 Operator and Organizational Maintenance Manual, Tank Combat, Full-Tracked 90MM Gun M48, M48A1 and M48C and Tank, Combat Full-Tracked, Flame Thrower M67

b. Action change codes indicated in the left hand margin of the listing page denote the following:

- N- Indicates an added item not included in previous publications
- C- Indicates a change in data
- F- Indicates a change in FSN only

5. How to Locate Repair Parts

a. When Federal stock number or reference number is unknown:

(1) *First.* Find the illustration covering the assembly group to which the repair part belongs.

(2) *Second.* Identify the repair part on the illustration and note the illustration figure and item number of the repair part.

(3) *Third.* Using the Repair Parts Listing, find the assembly group to which the repair part belongs and locate the illustration figure and item number noted on the illustration.

b. When Federal stock number or reference number is known:

(1) *First.* Using the Index of Federal Stock Numbers and Reference Numbers find the pertinent Federal stock number or reference number. This index is in ascending FSN sequence followed by a list of reference numbers in ascending alpha-numeric sequence, cross-referenced to the illustration figure number and item number.

(2) *Second.* Using the Repair Part Listing, find the assembly group of the repair part and the illustration figure number and item number referenced in the Index of Federal Stock Numbers and Reference Numbers.

6. Abbreviations

<i>Abbreviations</i>	<i>Explanation</i>
al-----	aluminum
aly-----	alloy
cd pll-----	cadmium plate
ck-----	cork
cres-----	corrosion-resistant steel
cksh-----	countersunk head
flh-----	flat head
fns -----	finish
fp-----	flat point
gl-----	glass
hex-----	hexagon
id .-----	inside diameter
l-----	long
NC-----	National coarse
NF-----	National fine
no-----	number
NS-----	National special
oa-----	overall
od-----	outside diameter
pnh-----	pan head
psvt-----	passivate
rec-----	recess
skt-----	socket
stl-----	steel
thk-----	thick
UNF-----	Unified fine thread

7. Federal Supply Codes for Manufacturers

<i>Code</i>	<i>Manufacturer</i>
19200	Frankford Arsenal, Philadelphia, Pa.
21450	Ordnance Corps Engineering Standards, Rock Island Arsenal, Rock Island, Illinois
71321	Carpenter Steel Co., 150 w. Bern Street, Reading, Pa.
96906	Military Standard Promulgated by Standardization Division, Directorate of Logistic Services DSA

8. Recommendations for Maintenance Publication Improvements

Report of errors, omissions, and recommendations for improving this publication by the individual user is encouraged. Reports should be submitted on DA Form 2028 (Recommended Changes to DA Publications) and forwarded direct to Commanding Officer, Frankford Arsenal, ATTN: AMSWE-SMF-W3100, Philadelphia, Pa. 19137.

Section II. DIRECT SUPPORT, GENERAL SUPPORT and DEPOT MAINTENANCE REPAIR PARTS

Act on code	(1) SMR code	(2) Federal stock No.	(3) Description <i>Reference Number & Mfr Code Usable On Code</i>	(4) Unit of Meas	(5) Qty inc in unit	(6) 30-Day DS Maint Allowance			(7) 30-Day GS Maint Allowance			(8) 1-yr alw per 100 equip cntgcy	(9) Depot maint Alw per 100 equip	(10) Illustration	
						(a) 1-20	(b) 21-50	(c) 51-100	(a) 1-20	(b) 21-50	(c) 51-100			(a) Figure No.	(b) Item No.
						C	P-F-	1240-766-0722	TELESCOPE M97 (7660688), M97G (7677382), AND M97H (7689443) WINDOW, OBSERVATION (BONDED AND CEMENTED) 7660722 (19200)	EA	1			*	2
C	P-F-	5330-76-0721	WASHER 7660721 (19200)	EA	1	*	2	2	*	2	2	24	10	1	2
N	X1-		WINDOW 7660734 (19200)		1									1	3
N	X1-		CELL, WINDOW 760720 (19200)		1									1	4
C	P-F-	5340-285-7114	RING, SPLIT 7660737 (19200)	EA	2	*	2	2	*	2	2	24	10	1	5
C	P-H	1240-764-3848	HOLDER, BRAZED 7643848 (19200)	EA	1				*	*	2	24	5	1	6
N	X1-		ROD 7593613 (19200)		2									1	7
N	X1-		HOLDER 7593612 (19200)		1									1	8
C	P-O-	1240-764-0492	EYESHIELD BONDED 7640492 (19200)	EA	1	*	2	2	*	2	2	24	30	1	9
N	X1-		EYESHIELD 7691571 (19200)		1									1	10
N	X1-		ADAPTER 7673141 (19200)		1									1	11
N	P-F-	5305-057-0497	SCREW, MACHINE PNH, CROSS, REC, CRES, PSVT FNSH, NO 2 64UNF-2A, 1/8 L MS51958-1 (96906)	EA	2	*	2	2	*	2	2	24	10	1	12
N	P-F-	1240-607-9545	PLATE, IDENTIFICATION 7667326 (19200) A	EA	1	*	*	2	*	*	2	24	4	1	13
N	P-F-	9905-460-7224	PLATE, IDENTIFICATION 76777379 (19200) B	EA	1	*	*	2	*	*	2	24	4	1	14
N	P-F-	9905-181-1039	PLATE, IDENTIFICATION 7689400 (19200) C	EA	1	*	*	2	*	*	2	24	4	1	15

1

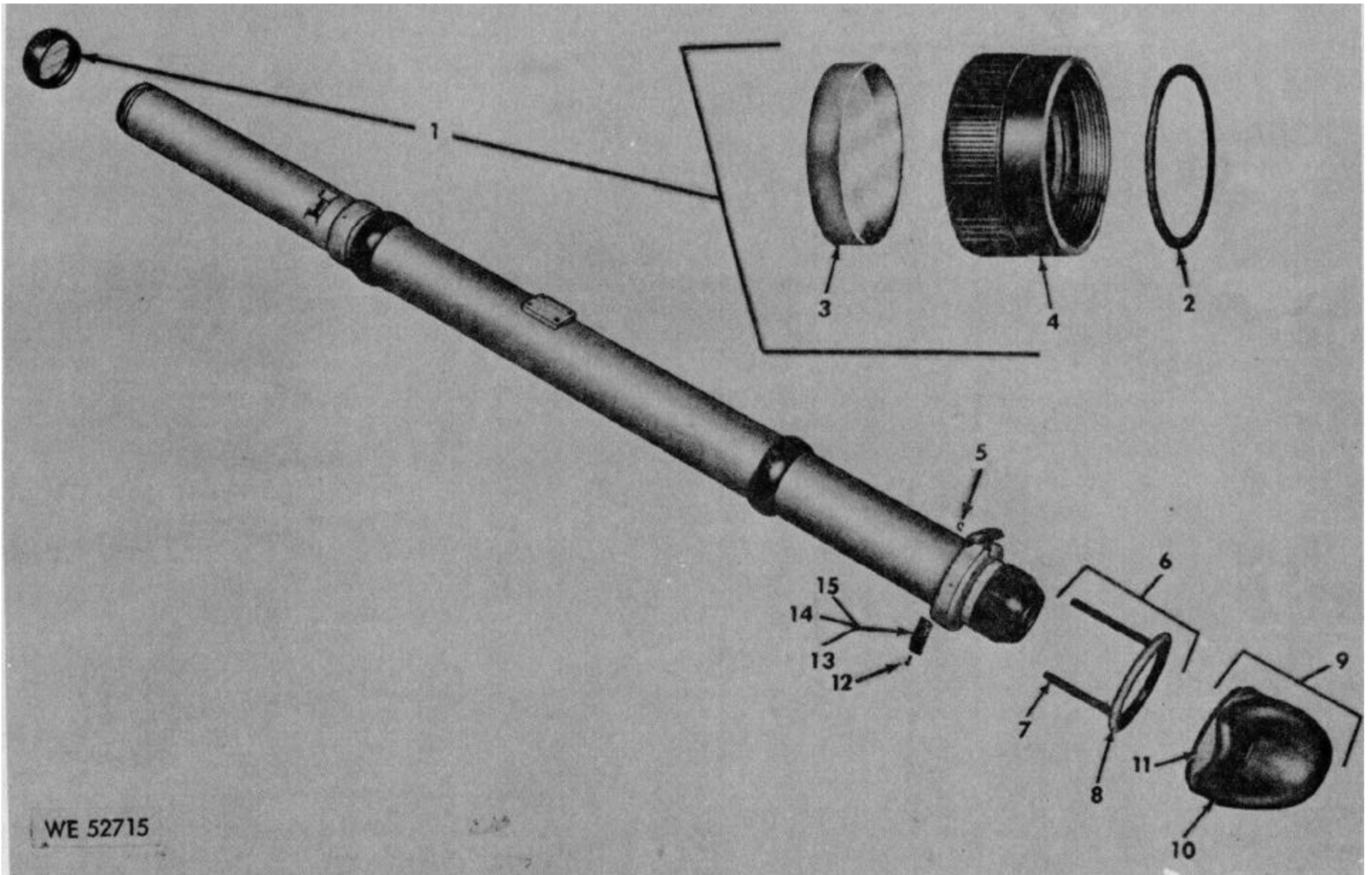

WE 52715

Figure 1. Telescope M97, M97G, and M97H--partial exploded view.

Act on code	(1)	(2)	(3)	(4)	(5)	(6)			(7)			(8)	(9)	(10)	
	SMR code	Federal stock No.	Description <i>Reference Number & Mfr Code Usable On Code</i>	Unit of Meas	Qty inc in unit	30-Day DS Maint Allowance			30-Day GS Maint Allowance			1-yr alw per 100 equip cntgcy	Depot maint Alw per 100 equip	Illustration	
						(a) 1-20	(b) 21-50	(c) 51-100	(a) 1-20	(b) 21-50	(c) 51-100			(a) Figure No.	(b) Item No.
C	X2-D-	1240-766-0709	TELESCOPE M97 (7660688), M97G (7677382), AND M97H (7689443)	EA	1									2	1
N	X1-		NUT STL, 2 17/32-32NS-2 7660709 (19200)		1									2	2
N	X1-		RETICLE AND OBJECTIVE ASSEMBLY 7660691 (19200) A		1									2	3
N	X1-		RETICLE AND OBJECTIVE ASSEMBLY 7677381 (19200) B		1									2	4
			RETICLE AND OBJECTIVE ASSEMBLY 7689442 (19200) C		1										

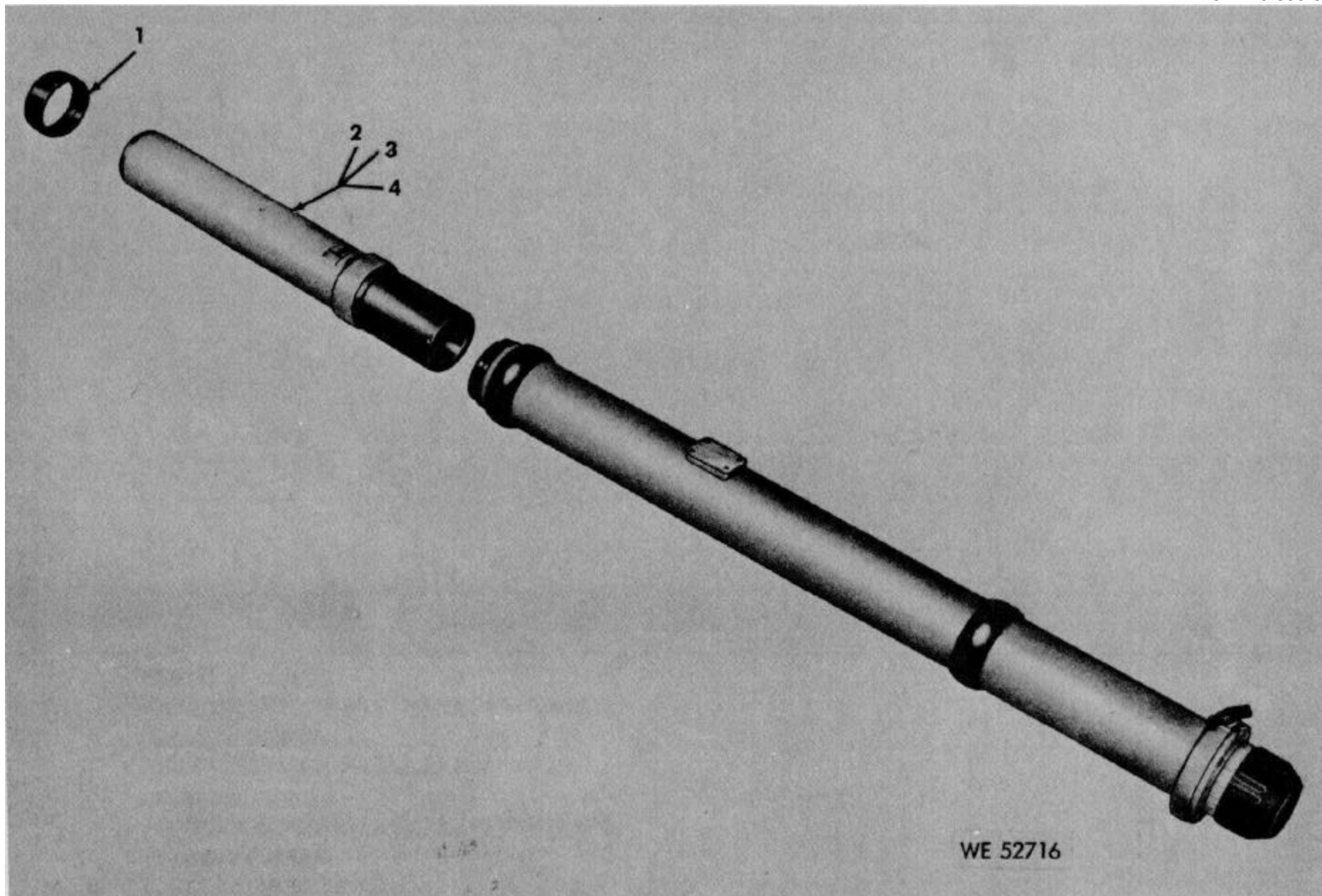

WE 52716

Figure 2. Telescope M97, M97G, and M97H--partial exploded view.

Act on code	(1) SMR code	(2) Federal stock No.	(3) Description <i>Reference Number & Mfg Code Usable On Code</i>	(4) Unit of Meas	(5) Qty inc in unit	(6) 30-Day DS Maint Allowance			(7) 30-Day GS Maint Allowance			(8) 1-yr alw per 100 equip cntgcy	(9) Depot maint Alw per 100 equip	(10) Illustration	
						(a) 1-20	(b) 21-50	(c) 51-100	(a) 1-20	(b) 21-50	(c) 51-100			(a) Figure No.	(b) Item No.
						N	P-F -	5305-719-5342	TELESCOPE M97 (7660688), M97G (7677382), AND M97H (7689443) SETSCREW HEX SKT, FP, ALY STL, CD PL, NO 8 32UNC-3A, 3/16 L MS51963-34 (96906)	EA	3			2	2
C	P-H	1240-766-0727	SCALE, DIOPTR 7660727 (19200)	EA	1				*	2	2	24	5	3	2
N	P-H	5305-071-1322	SCREW, MACHINE FL C SKH, CROSS REC, CRES, PSVT FNSH, NO 10 32UNF-2A, 1/2 L MS51960-65 (96906)	EA	4				*	2	2	24	10	8	8
N	A-		EYEPIECE ASSEMBLY 7660692 (19200)		1									3	4
C	P-D-	5310-638-3643	WASHER (DIAPHRAGM) 7660710 (19200)	EA	1								10	3	5
C	P-F-	5305-022-7073	SCREW, MACHINE FLH, CRES, NO 5 0.125 40NC-2, 1/4 227073 (96906)	EA	8	2	2	2	2	2	2	24	20	3	6
C	X2-D-	1240-766-0714	COVER 7660714 (19200)	EA	1									3	7
N	P-F-	2915-755-7528	SCREW 589066 (96906)	EA	1	*	2	2	*	2	2	24	10	3	8
N	X1-		ERECTOR ASSEMBLY 7660736 (19200)		1									3	9

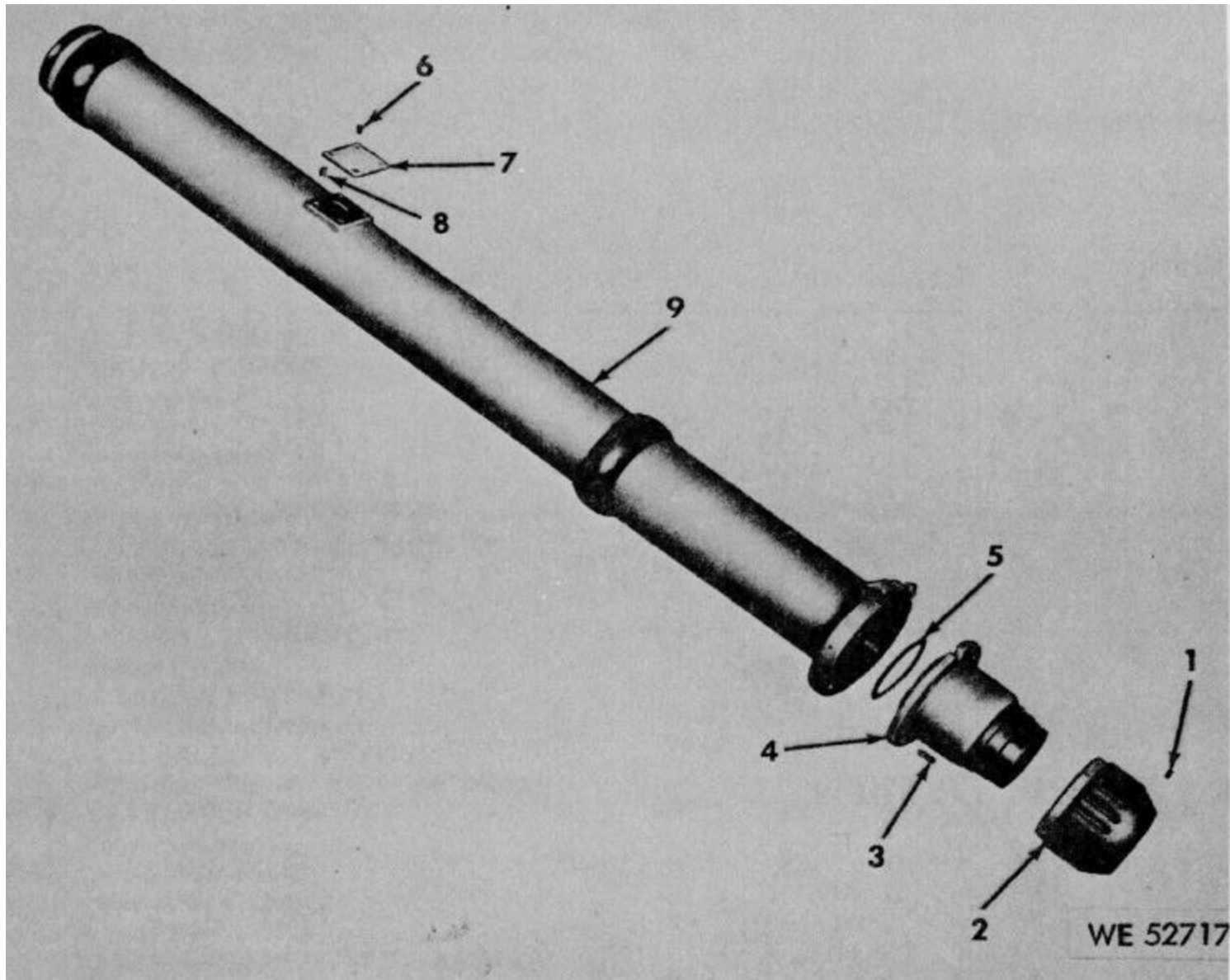

Figure 3. Telescope M97, M97G, and M97H-partial exploded view.

Act on code	(1) SMR code	(2) Federal stock No.	(3) Description <i>Reference Number & Mfg Code Usable On Code</i>	(4) Unit of Meas	(5) Qty inc in unit	(6) 30-Day DS Maint Allowance			(7) 30-Day GS Maint Allowance			(8) 1-yr alw per 100 equip cntgcy	(9) Depot maint Alw per 100 equip	(10) Illustration	
						(a) 1-20	(b) 21-50	(c) 51-100	(a) 1-20	(b) 21-50	(c) 51-100			(a) Figure No.	(b) Item No.
						N	A-		OBJECTIVE WITH RETICLE ASSEMBLY- 7660691, 7677381 AND 7689442 OBJECTIVE ASSEMBLY 7660693 (19200)		1				
N	P-D-	5305-724-6782	SETSCREW HEX SKT FP, ALY STL, CD PL, NO 8 32UNC-3A, 3/16 L MS51965-28 (96906)	EA	2							10	4	2	
N	P-D-	5340-200-5481	RING, EXTERNALLY THREADED 7648845 (19200)	EA	1							5	4	3	
N	A-		RETICLE ASSEMBLY 7660695 (19200) A		1								4	4	
N	A-		RETICLE ASSEMBLY 7677380 (19200) B		1								4	5	
N	A-		RETICLE ASSEMBLY 7 89441 (19200) C		1								4	6	
N	P-D-	5315-845-9401	PIN, STRAIGHT 544116 (21450)	EA	1							5	4	7	
C	P-D-	6210-548-0296	LENS, INDICATOR, LIGHT RED GL, 0.24 DIA, 0.031 THK 7583983 (19200)	EA	1							5	4	8	
C	P-D-	1240-766-0699	TUBE, OPTICAL INSTRUMENT 7660699 (19200)	EA	1							3	4	9	

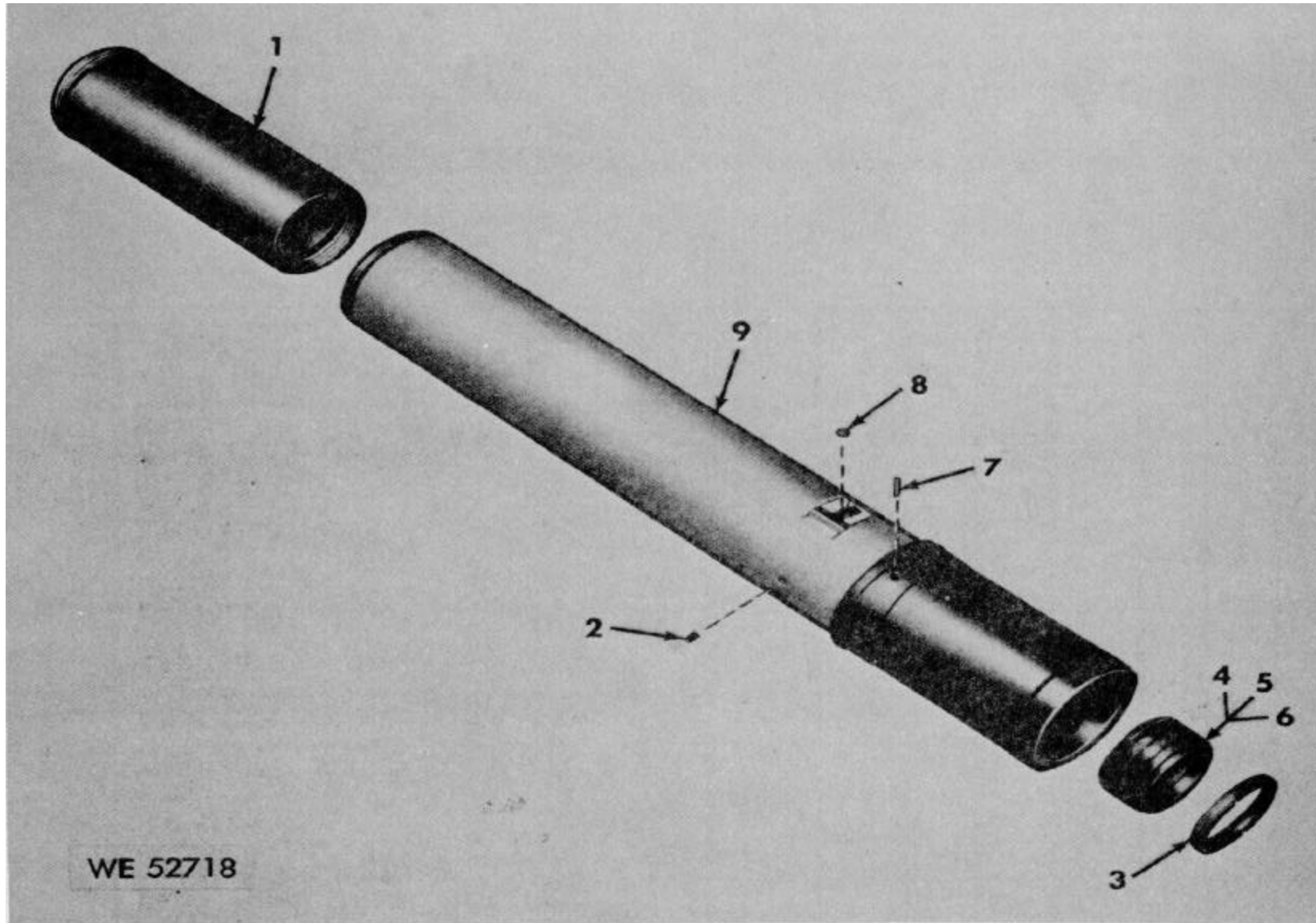

Figure 4. Objective with reticle assembly.

Act on code	(1)	(2)	(3)	(4)	(5)	(6)			(7)			(8)	(9)	(10)		
	SMR code	Federal stock No.	Description <i>Reference Number & Mfg Code Usable On Code</i>	Unit of Meas	Qty inc in unit	30-Day DS Maint Allowance			30-Day GS Maint Allowance			1-yr alw per 100 equip cntgcy	Depot maint Alw per 100 equip	Illustration		
						(a) 1-20	(b) 21-50	(c) 51-100	(a) 1-20	(b) 21-50	(c) 51-100			(a) Figure No.	(b) Item No.	
N	A-		OBJECTIVE ASSEMBLY-7660693		1										5	1
C	P-D-	1240-766-0731	CELL ASSEMBLY 7660694 (19200) RING, RETAINING AL ALY, 1.80 ID, 2 32NS-2 OD, 7/32 THK 7660731 (19200)	EA	1								10		5	2
C	P-D-	1240-766-0733	LENS, OBJECTIVE 7660733 (19200)	EA	1								10		5	3
C	P-D-	5340-200-5483	DIAPHRAGM AL ALY, 1.262 ID, 1 3/4-32NS-2 OD, 5/16 THK 7660717 (19200)	EA	1								5		5	4
C	P-D-	1240-766-0719	CELL, OBJECTIVE 7660719 (19200)	EA	1								5		5	5

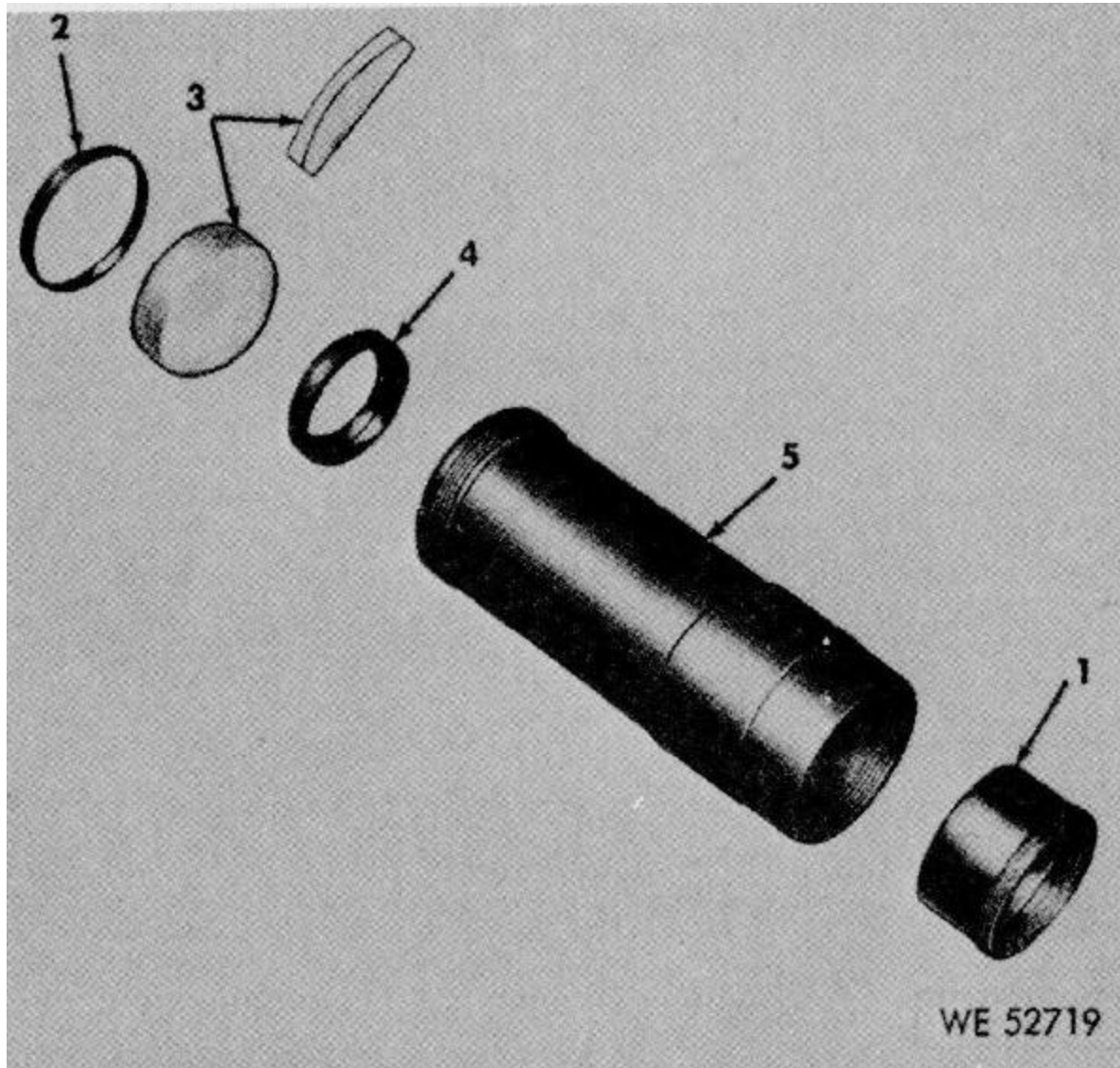

Figure 5. Objective assembly.

Act on code	(1) SMR code	(2) Federal stock No.	(3) Description <i>Reference Number & Mfg Code Usable On Code</i>	(4) Unit of Meas	(5) Qty inc in unit	(6) 30-Day DS Maint Allowance			(7) 30-Day GS Maint Allowance			(8) 1-yr alw per 100 equip cntgcy	(9) Depot maint Alw per 100 equip	(10) Illustration	
						(a) 1-20	(b) 21-50	(c) 51-100	(a) 1-20	(b) 21-50	(c) 51-100			(a) Figure No.	(b) Item No.
						C	P-D-	5340-200-5479	OBJECTIVE CELL ASSEMBLY-7660719 RING, EXTERNALLY THREADED AL ALY, 1.612 ID, 113/16-32NS-2 OD, 1/4 THK 7660718 (19200)	EA	1				
C	P-D-	1240-759-3585	LENS, OPTICAL INSTRUMENT 7593585 (19200)	EA	1								16	6	2
C	P-D-	1240-766-0708	CELL, OBJECTIVE 7660708 (19200)	EA	1								7	6	3

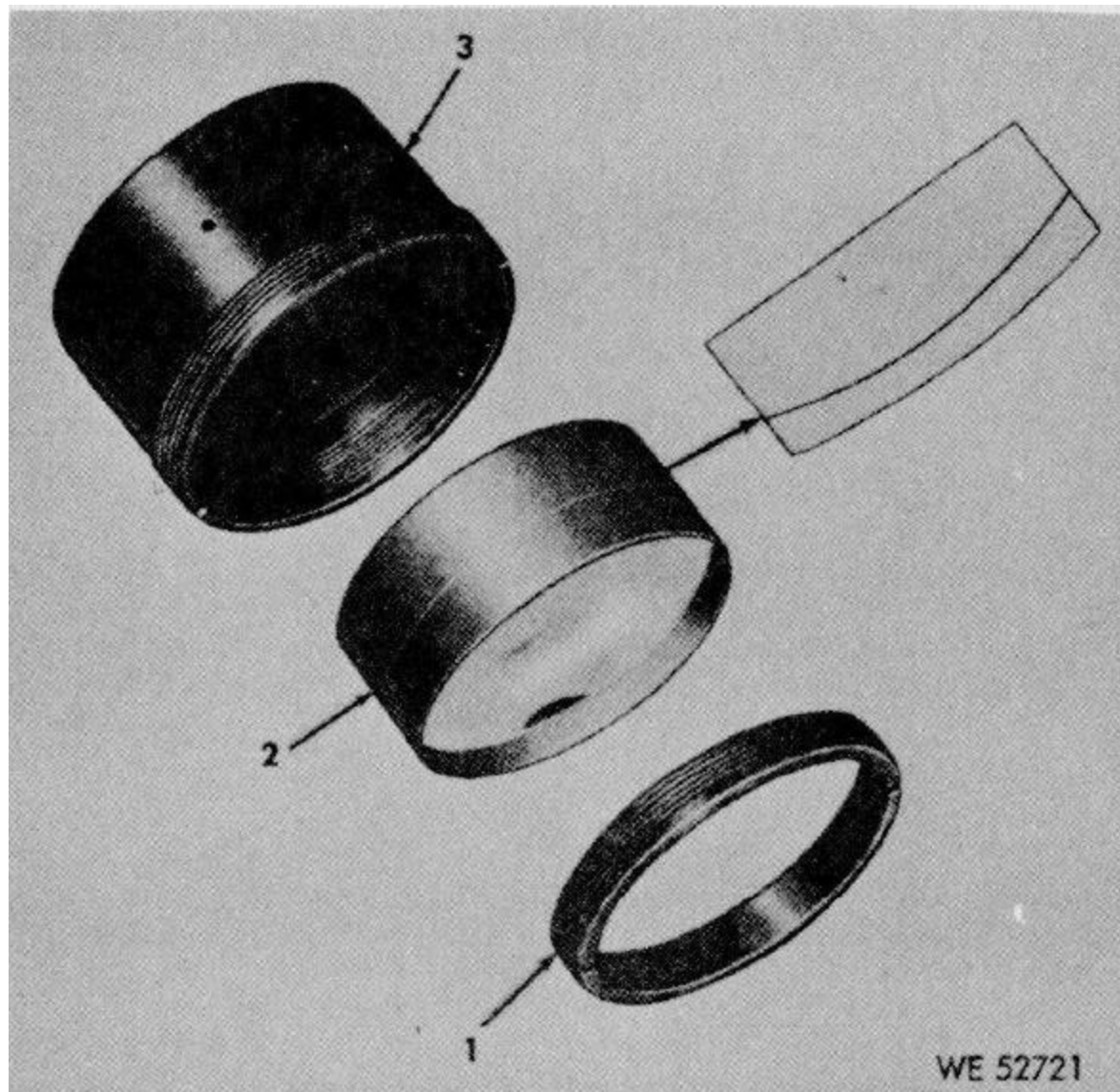

Figure 6. Objective cell assembly.

Act on code	(1)	(2)	(3)	(4)	(5)	(6)			(7)			(8)	(9)	(10) Illustration	
	SMR code	Federal stock No.	Description <i>Reference Number & Mfg Code Usable On Code</i>	Unit of Meas	Qty inc in unit	30-Day DS Maint Allowance			30-Day GS Maint Allowance			1-yr alw per 100 equip cntgcy	Depot maint Alw per 100 equip	(a)	(b)
						(a) 1-20	(b) 21-50	(c) 51-100	(a) 1-20	(b) 21-50	(c) 51-100			Figure No.	Item No.
C	P-D-	5340-200-5484	RETICLE ASSEMBLY-7660695, 7677380 AND 7689441 RING, EXTERNALLY THREADED AL ALY, 1.03 ID, 1 1/4-32NS-2 OD, 1/4 THK 7660706	EA	1								6	7	1
C	P-D-	1240-731-8388	RETICLE, OPTICAL INSTRUMENT 8619730 (19200) B	EA	1								10	7	2
C	P-D-	1240-766-0732	RETICLE, OPTICAL INSTRUMENT 7660732 (19200) A	EA	1								10	7	3
C	P-D-	1240-604-1304	RETICLE, OPTICAL INSTRUMENT 7689439 (19200) C	EA	1								10	7	4
C	P-D-	1240-766-0705	CELL, RETICLE 7660705 (19200)	EA	1								7	7	5

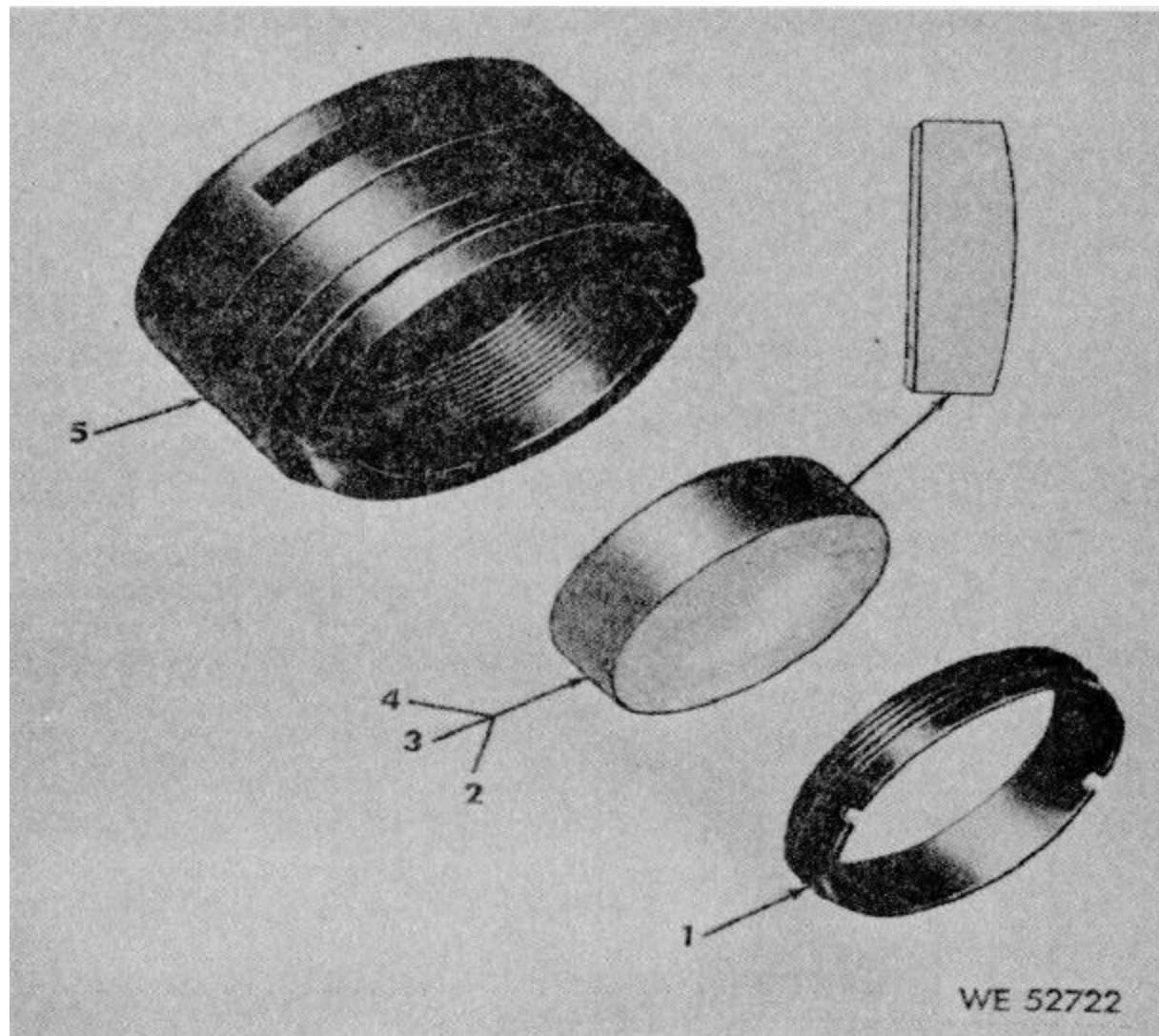
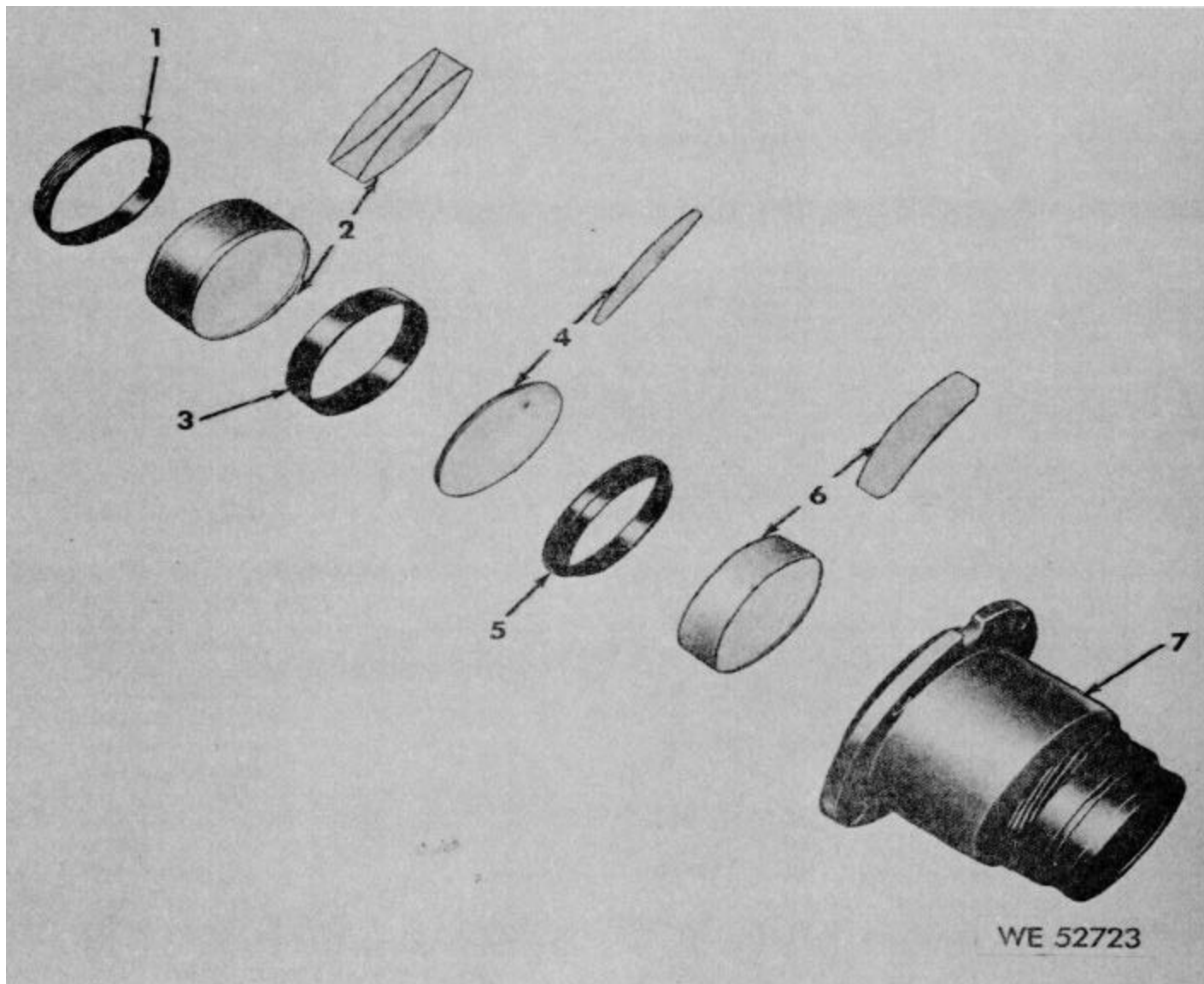

Figure 7. Reticle assembly.

Act on code	(1) SMR code	(2) Federal stock No.	(3) Description <i>Reference Number & Mfg Code Usable On Code</i>	(4) Unit of Meas	(5) Qty inc in unit	(6) 30-Day DS Maint Allowance			(7) 30-Day GS Maint Allowance			(8) 1-yr alw per 100 equip cntgcy	(9) Depot maint Alw per 100 equip	(10) Illustration	
						(a) 1-20	(b) 21-50	(c) 51-100	(a) 1-20	(b) 21-50	(c) 51-100			(a) Figure No.	(b) Item No.
						C	P-D -	5340-285-7904	EYEPIECE ASSEMBLY-7660692 RING, EXTERNALLY THREADED AL ALY, 1.884 ID, 21/16-32NS-OD, 5/16 THK 7593598 (19200)	EA	1				
C	P-D-	1240-759-3587	LENS, FIELD 7593587 (19200)	EA	1								16	8	2
C	X2-D-	1240-553-8993	SEPARATOR, OPTICAL AL ALY, 1.884 ID, 1.982 OD, 0.412 THK 7593597 (19200)	EA	1									8	3
C	P-D-	1240-759-3588	LENS, CENTER 7593588 (19200)	EA	1								12	8	4
C	P-D-	1240-759-3600	SEPARATOR AL ALY, 1.633 ID, 1.982 OD, 0.310 OA 7593600 (19200)	EA	1								6	8	5
C	P-D-	1240-759-3589	EYELENS 7593589 (19200)	EA	1								16	8	6
N	A-		EYEPIECE ASSEMBLY STRIPPED 7660739 (19200)		1									8	7



Act on code	(1) SMR code	(2) Federal stock No.	(3) Description <i>Reference Number & Mfg Code Usable On Code</i>	(4) Unit of Meas	(5) Qty inc in unit	(6) 30-Day DS Maint Allowance			(7) 30-Day GS Maint Allowance			(8) 1-yr alw per 100 equip cntgcy	(9) Depot maint Alw per 100 equip	(10) Illustration	
						(a)	(b)	(c)	(a)	(b)	(c)			(a) Figure No.	(b) Item No.
						1-20	21-50	51-100	1-20	21-50	51-100				
N	P-D-	1240-438-4648	STRIPPED EYEPIECE ASSEMBLY-7660739 ADAPTER, EYEPIECE 7660729 (19200)	EA	1								2	9	1
N	P-D-	5330-297-5380	PACKING, PREFORMED 8237431 (19200)	EA	1								28	9	2
N	P-D	1240-438-4640	CELL, EYEPIECE 7660726 (19200)	EA	1								2	9	3

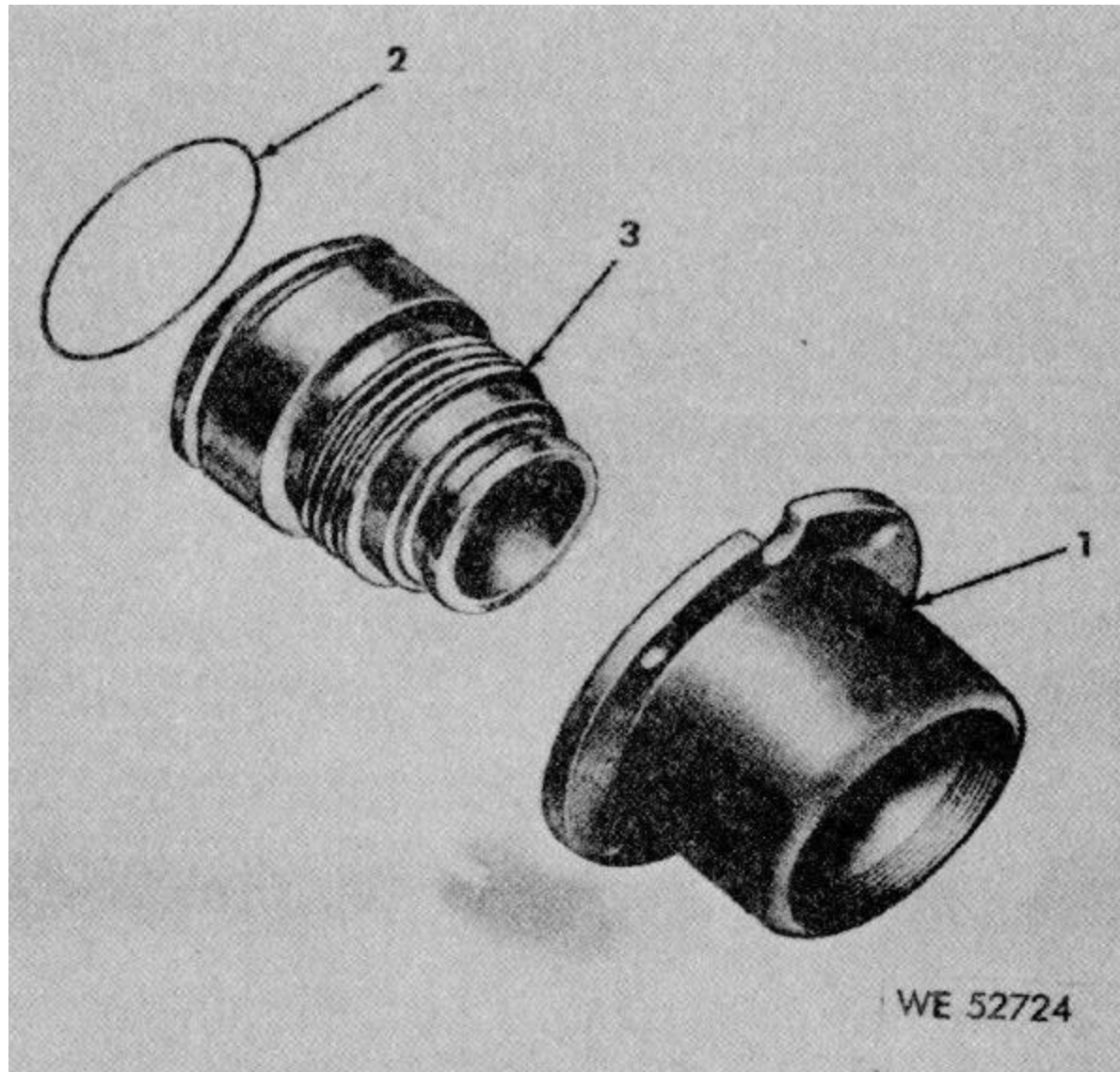

Figure 9. Stripped eyepiece assembly.

Act on code	(1) SMR code	(2) Federal stock No.	(3) Description <i>Reference Number & Mfg Code Usable On Code</i>	(4) Unit of Meas	(5) Qty inc in unit	(6) 30-Day DS Maint Allowance			(7) 30-Day GS Maint Allowance			(8) 1-yr alw per 100 equip cntgcy	(9) Depot maint Alw per 100 equip	(10) Illustration	
						(a) 1-20	(b) 21-50	(c) 51-100	(a) 1-20	(b) 21-50	(c) 51-100			(a) Figure No.	(b) Item No.
						N	A-		ERECTOR ASSEMBLY-7660736 CELL ASSEMBLY 7660696 (19200)		1				
C	P-D-	1240-766-0707	RING, EXTERNALLY THREADED AL ALY, 2.12 ID, 21/4-32NS-2 OD, 1/4 THK 7660707 (19200)	EA	1								10	10	2
C	P-D-	1240-759-3586	LENS, ERECTOR 7593586 (19200)	EA	1								26	10	3
C	P-D-	5315-042-6707	PIN, TAPERED STL, NO 6/0, 7/16 426707 (21450)	EA	2								10	10	4
C	P-F-	5355-766-0723	KNOB, WING AL ALY, 5/32 ID, 13/4 OA 7660723 (19200)	EA	2	*	2	2	*	2	2	24	20	10	5
C	P-F-	5305-022-7073	SCREW, MACHINE FLH, CRES, NO 50.125 40NC-2, 1/4 227073 (96906)	EA		REF	REF	REF	REF	REF	REF		REF	10	6
C	X2-D-	1240-660-072	PLATE STL, 1/2 W, 0.81 L, 0.078 THK, TWO CK HOLES FOR NO 6 SCREW 7660725 (19200)	EA	2									10	7
C	P-F-	5305-766-0724	SCREW, SPECIAL STL, 1/4-28NF-2 0.562 OA 7660724 (19200)	EA	2	*	2	2	*	2	2	24	10	10	8
N	P-D-	5315-460-4568	PIN, STRAIGHT, HEADLESS 7593617 (19200)	EA	1								4	10	9
N	X2-D-	1240-438-4637	TUBE, ERECTOR MACHINED 7660698 (19200)	EA	1									10	10
N	X1-		COLLAR 7660715 (19200)		1									10	11
N	X1-		COLLAR 7660716 (71321)		1									10	12
N	X1-		ADAPTER 7660713 (19200)		1									10	13
N	X1-		FLANGE 7660728 (19200)		1									10	14
N	X1-		TUBE, ERECTOR 7660704 (19200)		1									10	15

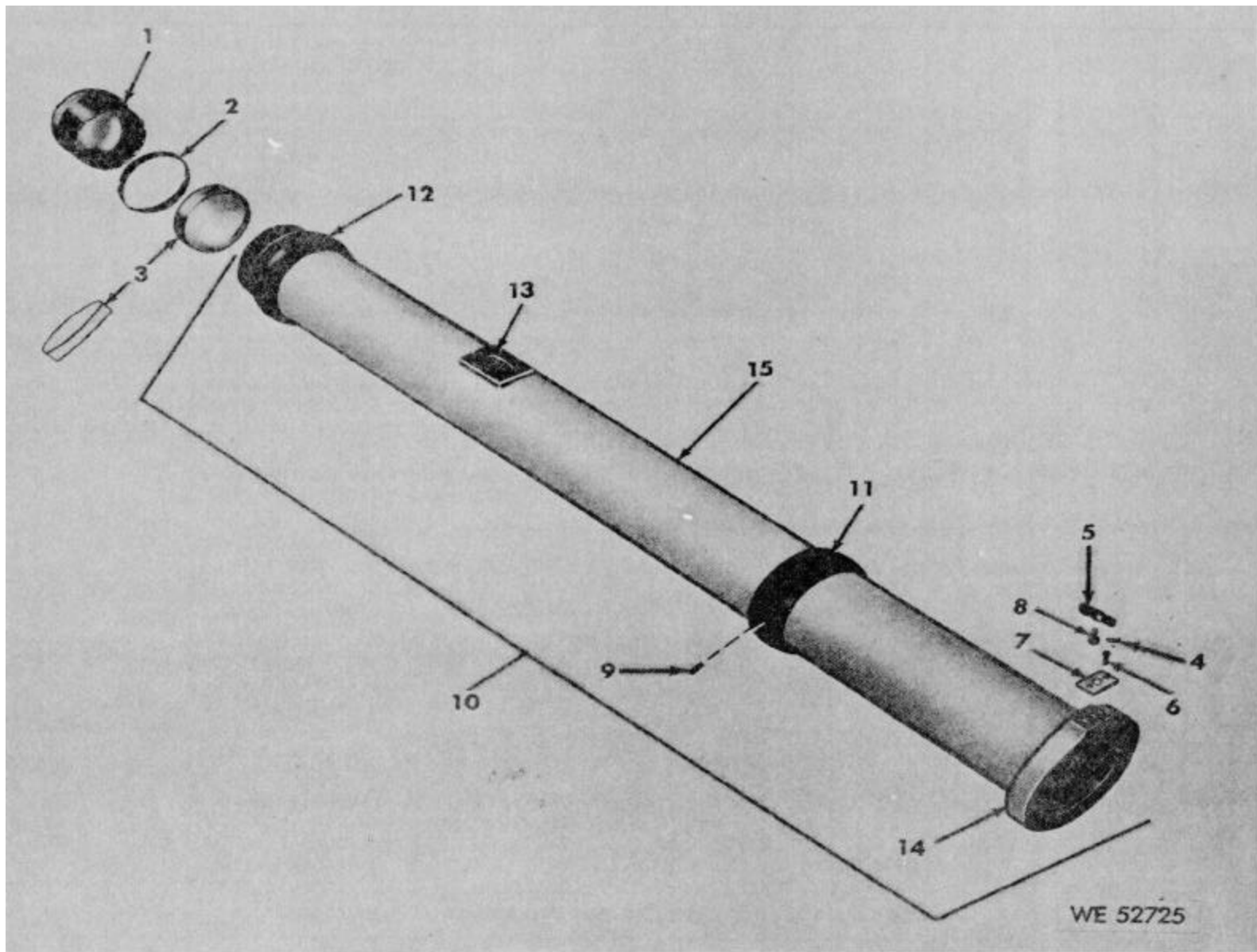

Figure 10. Erector assembly.

Act on code	(1) SMR code	(2) Federal stock No.	(3) Description <i>Reference Number & Mfg Code Usable On Code</i>	(4) Unit of Meas	(5) Qty inc in unit	(6) 30-Day DS Maint Allowance			(7) 30-Day GS Maint Allowance			(8) 1-yr alw per 100 equip cntgcy	(9) Depot maint Alw per 100 equip	(10) Illustration	
						(a) 1-20	(b) 21-50	(c) 51-100	(a) 1-20	(b) 21-50	(c) 51-100			(a) Figure No.	(b) Item No.
						C	P-D-	1240-766-0707	ERECTOR CELL ASSEMBLY-7660696 RING, EXTERNALLY THREADED AL ALY, 2.12 ID, 21/4-32NS-2 OD, 1/4 THK 7660707 (19200)	EA	1				
C	P-D-	1240-759-3586	LENS, ERECTOR 7593586 (19200)	EA	1								REF	11	2
C	P-D-	1240-766-0711	CELL, ERECTOR 7660711 (19200)	EA	1								7	11	3

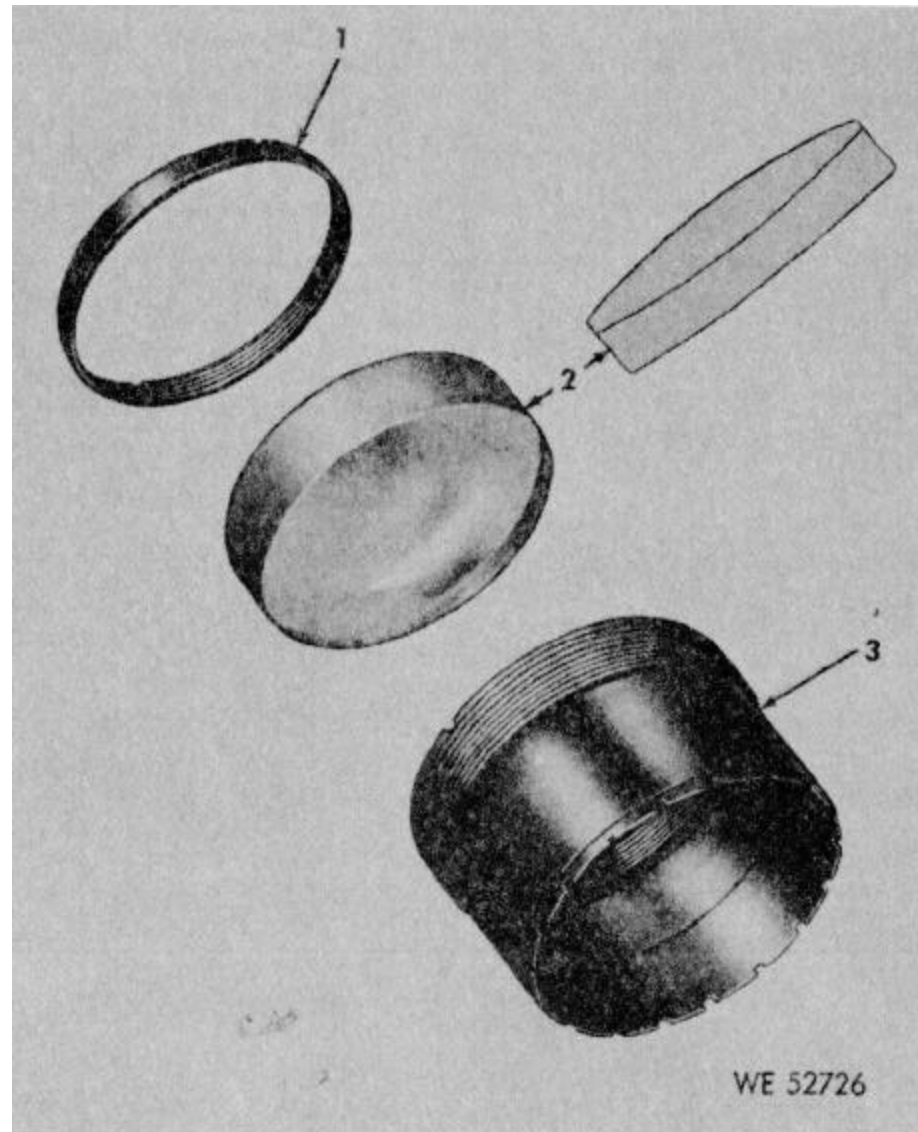

Figure 11. Erector cell assembly.

**Section III. SPECIAL TOOLS, TEST and SUPPORT EQUIPMENT
For DIRECT SUPPORT, GENERAL SUPPORT and DEPOT
MAINTENANCE REPAIR PARTS LIST**

Act on code	(1)	(2)	(3)		(4)	(5)	(6)			(7)			(8)	(9)	(10)	
	SMR code	Federal stock No.	Description <i>Reference Number & Mfg Code Usable On Code</i>		Unit of Meas	Qty inc in unit	30-Day DS Maint Allowance			30-Day GS Maint Allowance			1-yr alw per 100 equip cntgcy	Depot maint Alw per 100 equip	Illustration	
							(a) 1-20	(b) 21-50	(c) 51-100	(a) 1-20	(b) 21-50	(c) 51-100			(a) Figure No.	(b) Item No.
			NOT APPLICABLE													

Section IV. INDEX-FEDERAL STOCK NUMBER and REFERENCE NUMBER CROSS-REFERENCED TO FIGURE AND ITEM NUMBER

<i>STOCK NUMBER</i>	<i>FIGURE NO.</i>	<i>ITEM NO.</i>	<i>REFERENCE NO.</i>	<i>MFR CODE</i>	<i>FIGURE NO.</i>	<i>ITEM NO</i>
1240-438-4637	10	10				
1240-438-4640	9	3	426707	21450	10	4
1240-438-4648	9	1	544116	21450	4	7
1240-553-8993	8	3	589066	96906	3	8
1240-604-1304	7	4	7583983	19200	4	8
1240-607-9545	1	13	7593585	19200	6	2
1240-660-0725	10	7	7593586	19200	10	3
1240-731-8388	7	2	7593587	19200	8	2
1240-759-3585	6	2	7593588	19200	8	4
1240-759-3586	10	3	7593589	19200	8	6
1240-759-3586	11	2	7593597	19200	8	3
1240-759-3587	8	2	7593598	19200	8	1
1240-759-3588	8	4	7593600	19200	8	5
1240-759-3589	8	6	7593612	19200	1	8
1240-759-3600	8	5	7593613	19200	1	7
1240-764-0492	1	9	7593617	19200	10	9
1240-764-3848	1	6	7640492	19200	1	9
1240-766-0699	4	9	7643848	19200	1	6
1240-766-0705	7	5	7648845	19200	4	3
1240-766-0707	10	2	7660691	19200	2	2
1240-766-0707	11	1	7660692	19200	3	4
1240-766-0708	6	3	7660693	19200	4	1
1240-766-0709	2	1	7660695	19200	4	4
1240-766-0711	11	3	7660696	19200	10	1
1240-766-0714	3	7	7660698	19200	10	10
1240-766-0719	5	5	7660699	19200	4	9
1240-766-0722	1	1	7660704	19200	10	15
1240-766-0727	3	2	7660705	19200	7	5
1240-766-0731	5	2	7660706		7	1
1240-766-0732	7	3	7660707	19200	10	2
1240-766-0733	5	3	7660708	19200	6	3
5305-022-7073	10	6	7660709	19200	2	1
5305-022-7073	3	6	7660710	19200	3	5
5305-057-0497	1	12	7660711	19200	11	3
5305-071-1322	3	3	7660713	19200	10	13
5305-719-5342	3	1	7660714	19200	3	7
5305-724-6782	4	2	7660715	19200	10	11
5305-766-0724	10	8	7660716	71321	10	12
5310-638-3643	3	5	7660717	19200	5	4
5315-042-6707	10	4	7660718	19200	6	1
5315-845-9401	4	7	7660719	19200	5	5
5330-297-5380	9	2	7660720	19200	1	4
5330-766-0721	1	2	7660721	19200	1	2
5340-200-5479	6	1	7660722	19200	1	1
5340-200-5481	4	3	7660723	19200	10	5
5340-200-5483	5	4	7660724	19200	10	8
5340-200-5484	7	1	7660725	19200	10	7
5340-285-7114	1	5	7660726	19200	9	3
5340-285-7904	8	1	7660727	19200	3	2
5355-766-0723	10	5	7660728	19200	10	14
6210-548-0296	4	8	7660729	19200	9	1
9905-181-1039	1	15	7660731	19200	6	2
2915-755-7528	3	8	7660732	19200	7	3
5315-460-4568	10	9	7660733	19200	5	3
9905-460-7224	1	14	7660734	19200	1	3
			7660736	19200	3	9
			7660737	19200	1	5
			7660739	19200	8	7
			7667326	19200	1	13
			7673141	19200	1	11
			7677379	19200	1	14
			7677380	19200	4	5
			7677381	19200	2	3
<i>REFERENCE NO.</i>	<i>MFR CODE</i>	<i>FIGURE NO.</i>	<i>ITEM NO.</i>			
MS51958-1	96906	1	12			
MS51960-65	96906	3	3			
MS51963-34	96906	3	1			
MS51965-28	96906	4	2			
227073	96906	3	6			

<i>REFERENCE NO.</i>	<i>MFR CODE</i>	<i>FIGURE NO.</i>	<i>ITEM NO.</i>	<i>REFERENCE NO.</i>	<i>MFR CODE</i>	<i>FIGURE NO.</i>	<i>ITEM NO.</i>
7689439	19200	7	4	7691571	19200	1	10
7689440	19200	1	15	8237431	19200	9	2
7689441	19200	4	6	8619730	19200	7	2
7689442	19200	2	4				

By Order of the Secretary of the Army:

Official:

W. C. WESTMORELAND,
General, United States Army
Chief of Staff.

KENNETH G. WICKHAM,
Major General, United States Army,
The Adjutant General.

DISTRIBUTION:

To be distributed in accordance with DA Form 12-41 (qty rqr block no. 140) requirements for Direct and General Support Maintenance Instructions for Telescope.

TM 9-1240-335-35P

PIN: 027301-000